

# INSTALLATION INSTRUCTIONS FOR MODEL 850EC

IMPORTANT: REVIEW ALL INSTRUCTIONS, PARTS LISTS, & INSTALLATION DIAGRAMS BEFORE STARTING INSTALLATION

1. As shown in figure 2, slide the (2) grommets (item#3) into slots. Next push the (2) brass eyelets (item#2) into the grommets. Pull the (4) bumpers (item#5) through the (4) round holes on the bracket.
2. Clamp compressor head (item#12) and install fitting (item#8) into air outlet as shown in figure 4.
3. Note: Mount compressor on rigid support. Do not mount on fender well, firewall or other flexible material. Locate compressor in area with good air flow and away from road surface to avoid excessive water and dirt conditions. Mounting requires (2) holes spaced  $2 \frac{3}{16}$  in. apart, each having a diameter of  $\frac{7}{32}$  in. as shown in figure 1.
4. To mount compressor, insert 10-32 bolt (item#1) through the brass eyelet and through the  $\frac{7}{32}$  in. hole. Secure with the 10-32 nut (item#4) as shown in figure 2. **Do not overtighten mounting bolts.**
5. Connect nylon tubing from air outlet fitting using brass insert (item#7) and tube nut (item#6) to your application as shown in figure 4.
6. Install pressure switch (item#9) down line from compressor on a rigid support. Do not mount pressure switch on compressor head. **CAUTION:** Tighten pressure switch on brass hex body only.
7. As shown in figure 3 connect orange (+) wire using terminal (item#10) from compressor motor to either pressure switch terminal. Next, connect fuse holder assembly (item#11) to the other pressure switch terminal. Install other end of fuse holder assembly to "ignition activated" accessory terminal in fuse panel. Attach motor's black wire (-) to metal ground.

---

**NOTE:** Compressor starts automatically when pressure drops below 110 psi. If more than 4 minutes are required to pump tank to full pressure (110-135 psi) with engine running and compressor does not shut off, check all connections with soapy water or bubble solution for leaks. Use thread sealant on all uncoated pipe threads. Maximum cycle time 7 minutes with 30 minute cool down.

---

---

All Hadley products carry a limited warranty for 12 months from date of purchase. We will repair or replace, at our option, defects in material and workmanship during that period when product and proof of purchase are returned to our service department at the address below.

---

Hadley Products  
Attn: Service Department  
2851 Prairie S.W. Suite D  
Grandville, MI 49418

Service Department: (616) 249-8462  
Main: (616) 530-1717  
Fax: (616) 530-3283



[www.hadley-products.com](http://www.hadley-products.com)

# INSTALLATION DIAGRAM

FIGURE 1  
MOUNTING HOLE  
PATTERN

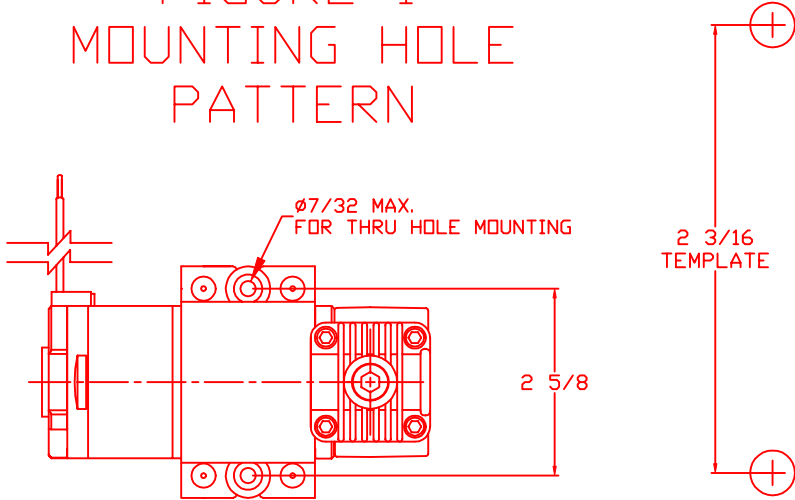

FIGURE 2  
BRACKET  
ASSEMBLY

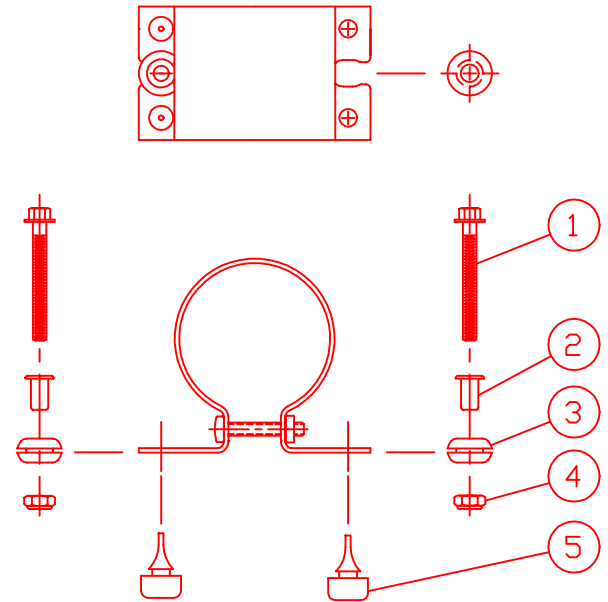

FIGURE 3  
ELECTRICAL  
ASSEMBLY

NOTE: PRESSURE SWITCH MUST BE MOUNTED RIGIDLY.  
EXAMPLE:  
-IN AIR OUTLET LINE  
-ON THE AIR TANK  
DO NOT MOUNT ON COMPRESSOR HEAD

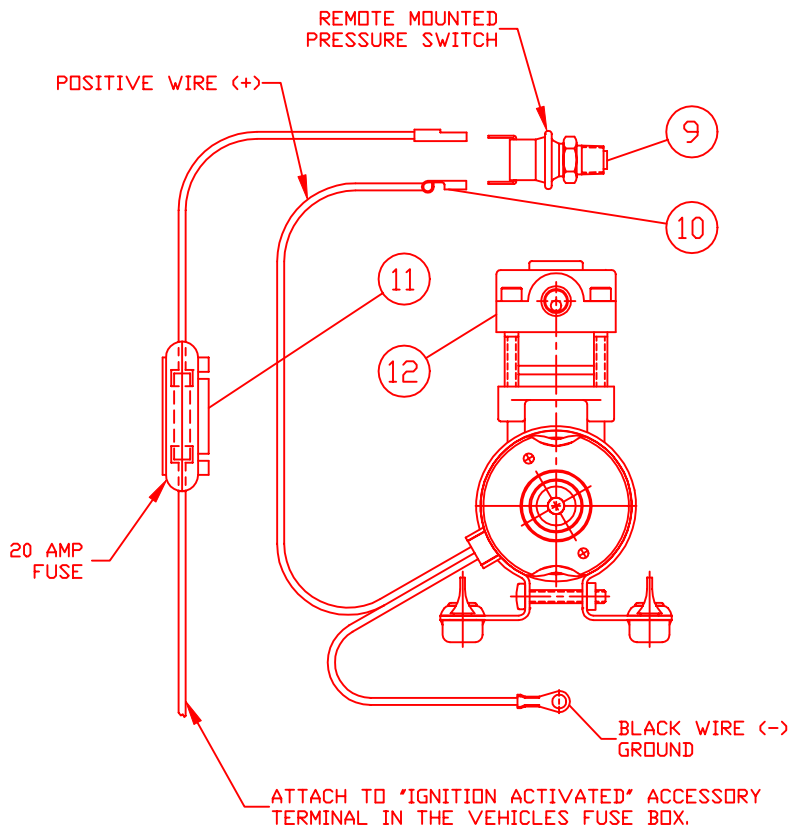
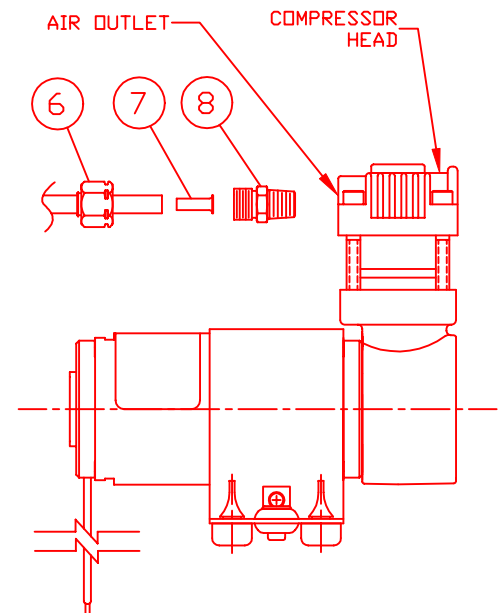

FIGURE 4  
FITTING  
ASSEMBLY



# PARTS LIST

(2)-QUANTITY  
BOLT 10-32  
H14168

①



(2)-QUANTITY  
EYELET  
H15224

②



(2)-QUANTITY  
GROMMET  
H15234

③

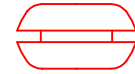

(2)-QUANTITY  
NUT 10-32  
H14591

④



(4)-QUANTITY  
BUMPER  
H14572

⑤

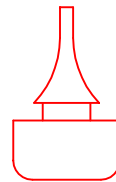

(1)-QUANTITY  
TUBE NUT  
H15522

⑥

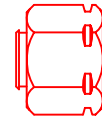

(1)-QUANTITY  
BRASS INSERT  
H12462

⑦

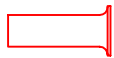

(1)-QUANTITY  
BRASS FITTING  
1/4 X 1/8  
H12553

⑧

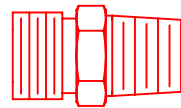

(1)-QUANTITY  
PRESSURE SWITCH  
H13940A

⑨

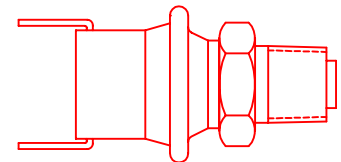

(1)-QUANTITY  
FEMALE TERMINAL  
H14620

⑩

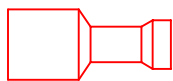

(1)-QUANTITY  
FUSE HOLDER  
H15235

⑪

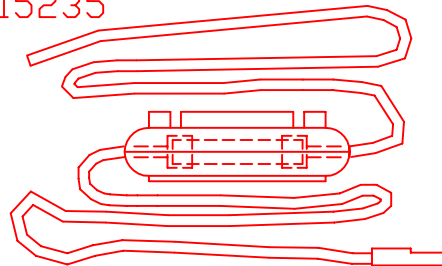

(1)-QUANTITY  
MODEL 850  
COMPRESSOR

⑫

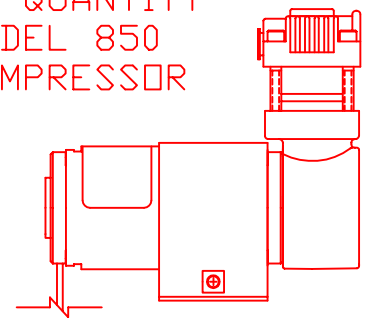

(1)-QUANTITY  
TEFLON THREAD  
SEALANT  
H13943

⑬

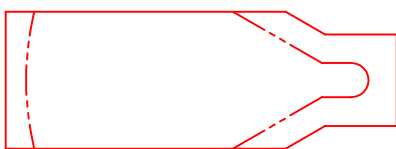

(2)-QUANTITY  
WIRE SPLICE CONNECTOR  
H13116

⑭

